

- B1/C -

AREA STATEMENT :
TOTAL AREA OF POKET: 41304.2 SQM
AREA OF BUILT UP (UNACQUIRED LAND): 157.48 SQM
NET AREA OF THE POKET: 41146.72 SQM

DETAILS OF PLOTS:

| PLOT NO. | USE | AREA (IN SQM) |
|----------|-----------------|-----------------|
| 1 | HOSPITAL | 4700.00 |
| 2 | FIRE STATION | 10042.69 |
| 3 | GENERAL COLLEGE | 15029.02 |
| | CIRCULATION | 11375.01 |
| | TOTAL | 41146.72 |

- NOTE:**
- LANDUSE OF THE POKET IS "PURNC & SEMI-PURNC" AS PER THE MASTER PLAN FOR DELHI-2021 AND ZONAL DEVELOPMENT PLAN (Z) ZONE - 'M'.
 - THIS DRAWING IS BASED ON THE SURVEY, DEMARCATION AND FEASIBILITY OF SECTOR 36 & 37 ROHINI PROVIDED BY EXECUTIVE ENGINEER, RPWLE VIDE LETTER NO P.3 (MISC.)/AE (P/RP/D-6000/RS DATED 27-01-2012.
 - DEVELOPMENT CONTROL NORMS AS PER MASTER PLAN FOR DELHI-2021.
 - ALL DIMENSIONS ARE IN METERS, ONLY WRITTEN DIMENSIONS ARE TO BE FOLLOWED.
 - THE TREES SHOWN ARE TO BE CONSIDERED / MAINTAINED / RETAINED BY THE INDIVIDUAL PLOT OWNERS WHILE DESIGNING OF SCHEMES OF PLOT/ GRADE SEPARATOR.
 - THE 20 M. WIDE ROAD BETWEEN PSP POKET FC-32 AND COMMUNITY FACILITY AND INDUSTRIAL AREA IS PROPOSED FROM AREA OF POKET OF CP / INDUSTRIAL.
 - THE PROPOSAL AS REFLECTED IN AGENDA WAS APPROVED IN THE 323rd SCREENING COMMITTEE MEETING HELD ON 29/05/2014 VIDE ITEM NO. 52/2014.

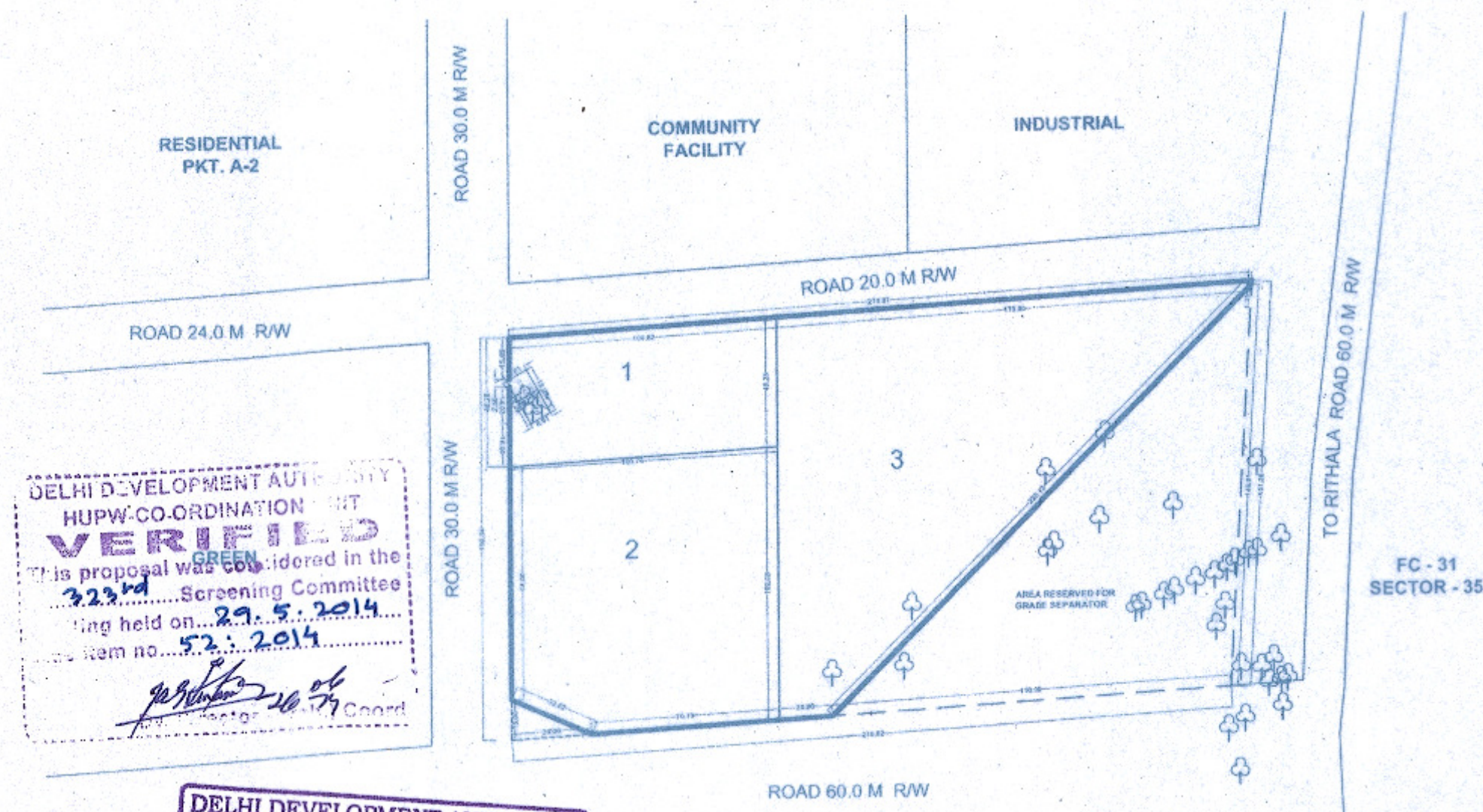
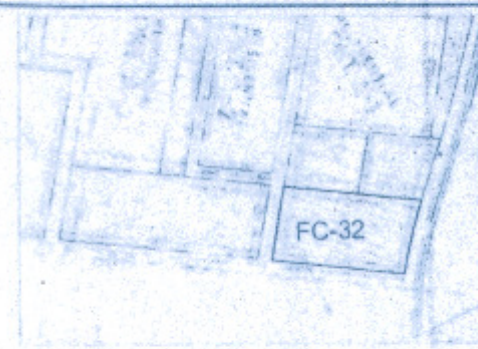

DELHI DEVELOPMENT AUTHORITY
HUPW-CO-ORDINATION UNIT
VERIFIED
This proposal was considered in the
323rd Screening Committee
Meeting held on 29.5.2014
vide Item no. 52:2014
[Signature]
Director (PLG) ROHINI, ZONE - M/EN

DELHI DEVELOPMENT AUTHORITY
CERTIFIED
Approved in 323rd Screening
Committee Meeting Dt. 29-05-2014
vide Item No. 52:2014
Sign. *[Signature]* 24/06/2014
Name **VINOD SAKLE**
Designation **DIRECTOR (PLG) ROHINI, ZONE - M/EN**

The Proposal has been approved by
the 323rd Screening Committee
held on 29-05-14 vide item No. 52:2014
in File No. Dir. (PLG) R/5036/FC-32/2014

PLG. ASSISTANT/AD(PLG) ON CONTRACT/R.

AD(PLG)-1/ROHINI

[Signature]
24/06/14
DY. DIRECTOR (PLG)-2 & D/R

FILE NO.: DIR/PLG./R/5036/FC-32/2014

**PROPOSED LAYOUT PLAN OF
FACILITY CENTER (FC-32),
SECTOR - 36, ROHINI, PHASE - V**

| | | |
|-------------|--------------------|------------------------------|
| Scale | 1:2000 | |
| Date | JUNE, 2014 | |
| Prepared by | PLG. ASST. | Work Done (Area) |
| Checked by | AD(PLG) | ASST. DIR. (PLG) ON CONTRACT |
| Approved by | Director (PLG) | |
| Designation | Director (PLG) | |
| Signature | <i>[Signature]</i> | |
| Date | 24/06/14 | |

रोहिणी
ROHINI
संयोजन कार्यालय - नई दिल्ली 110083
PLANNING OFFICE ROHINI PHASE - V